

Central Brass®

The Easy Choice

SLOW CLOSE STRAIGHT STOP

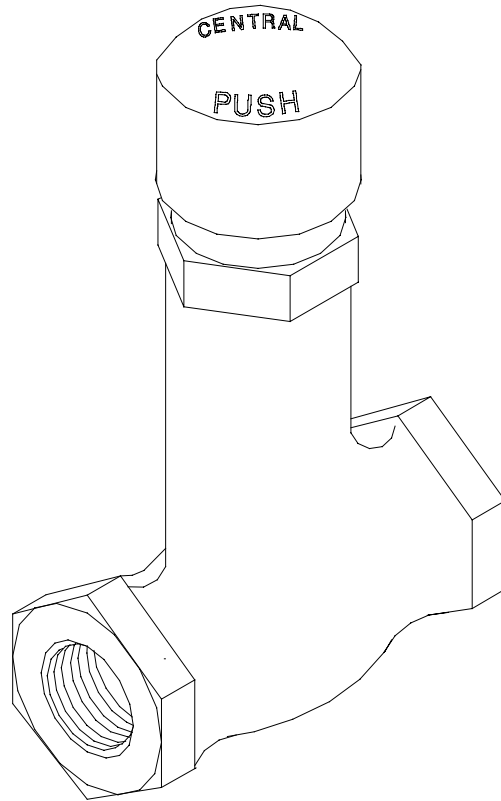

0336 Series Straight Stop Valve

CENTRAL BRASS MFG CO

2950 East 55th Street, Cleveland, Ohio 44127

Phone: 216-883-0220 Fax: 216-883-0875 Email: sales @CentralBrass.com

CENTRAL BRASS INSTALLATION INSTRUCTIONS

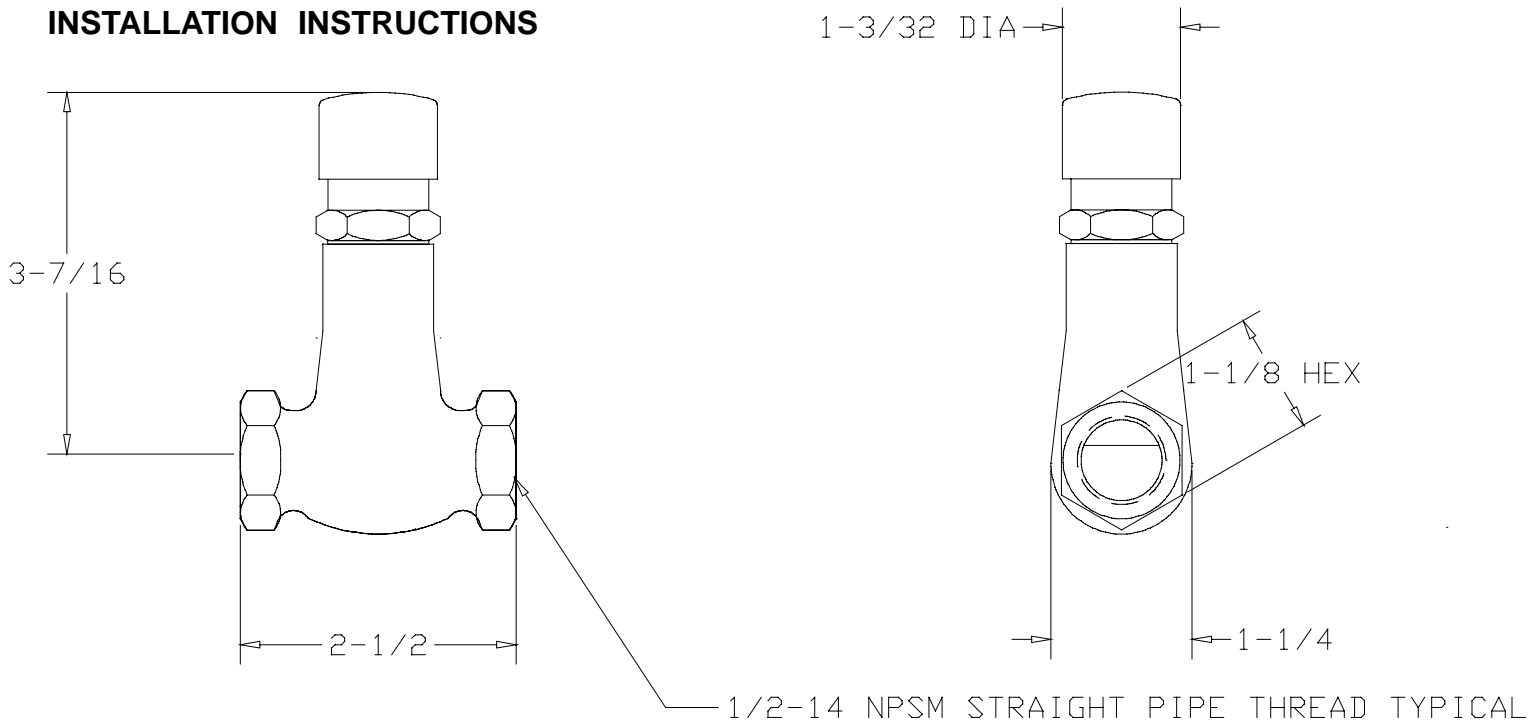

1. After installing operate a number of times to purge contamination and wet internal components.
2. Test the valve run time. The faucet should remain on for 3 to 5 seconds. Refer to adjustment instructions if required.

TIME DELAY ADJUSTMENT TO SLOW-CLOSING UNITS

The faucet is preset at five seconds running time at the factory. When faucet is installed, depress the handle several times before you try to adjust running time. This is necessary to properly wet the felt washer which helps control running time.

If running time is too long or too short: Loosen set screw in handle with $3/32$ hex wrench. Adjust unit for longer running time by turning handle counterclockwise. For shorter running time, turn handle clockwise. Handle should be turned in $1/2$ turn increments. After desired running time is achieved, retighten handle set screw to lock it in place. **DO NOT** turn handle over three turns off the bottom or set screw will not lock against the stem. This adjustment is limited to a range of 1 to 7 seconds. The time may be increased beyond 7 seconds by first shutting off water supply. Remove the slow-closing cartridge and tighten the screw (170-K) on the bottom of the time delay chamber in quarter turn increments.

NOTE: The felt washer will become clogged from contamination in the water. This condition is indicated by increase on time delay setting over the time originally set. Replace the felt washers when this occurs. If the faucet shuts off instantly and the time delay setting cannot be adjusted the seals in the time delay chamber are worn or damaged. Replace the cartridge.

CENTRAL BRASS MFG CO

2950 East 55th Street, Cleveland, Ohio 44127

Phone: 216-883-0220 Fax: 216-883-0875 Email: sales @CentralBrass.com

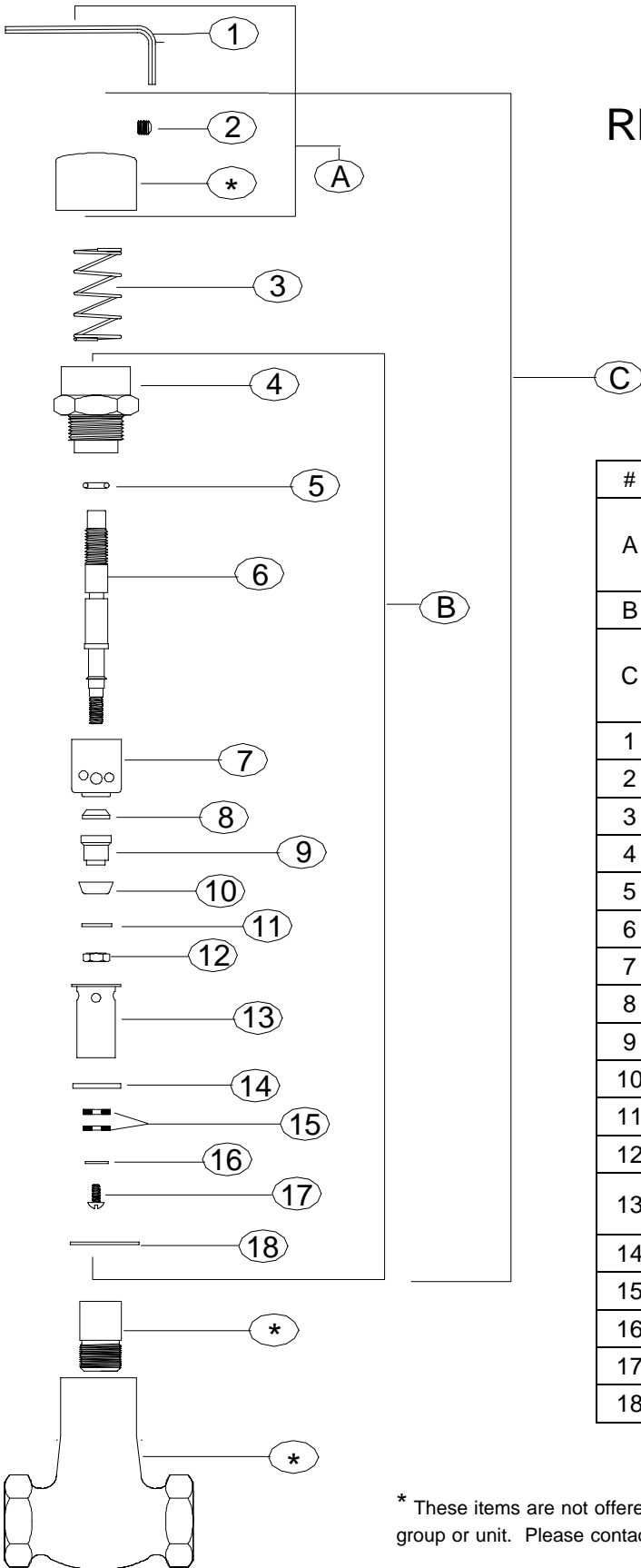

REPLACEMENT PARTS

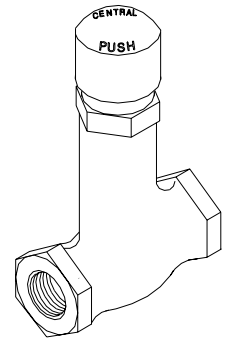

#	Part #	Description
A	K-170-AP	Slow-Close Cap Plain not indexed with Set Screw (X103-HS) & Wrench (170-WA)
B	K-170	Slow-Close Stem Assembly
C	K-170-P	Slow-Close Stem Assembly including Cap Plain not indexed and Set Screw (X103-HS)
1	170-WA	$\frac{3}{32}$ Allen Wrench
2	X103-HS	Set Screw (6 pcs per pack)
3	170-L	Spring
4	XPF-170-B	Bonnet (2 pcs per pack)
5	X1038-CRN	O-Ring (25 pcs per pack)
6	XPF-170-C	Stem (2 pcs per pack)
7	X353-S	Sleeve (10 pcs per pack)
8	X170-F	Seat Washer (10 pcs per pack)
9	XPF-170-D	Seat Washer Holder (2 pcs per pack)
10	X170-CW	Cup Washer (10 pcs per pack)
11	X279-L	Brass Washer (10 pcs per pack)
12	XPF-170-N	Hex Nut (10 pcs per pack)
13	XPF-170-E	Brass Dashpot chrome plated (2 pcs per pack)
14	X170-P	Gasket (10 pcs per pack)
15	X170-J	Felt Washer (10 pcs per pack)
16	X170-H	Brass Dashpot Washer (10 pcs per pack)
17	X170-K	Screw (10 pcs per pack)
18	X1028-Y	Gasket (25 pcs per pack)

* These items are not offered individually and must be purchased as a group or unit. Please contact Central Brass for more information.

CENTRAL BRASS MFG CO

2950 East 55th Street, Cleveland, Ohio 44127

Phone: 216-883-0220 Fax: 216-883-0875 Email: sales @CentralBrass.com

CENTRAL BRASS MAINTENANCE INSTRUCTIONS

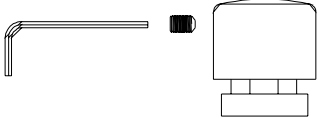
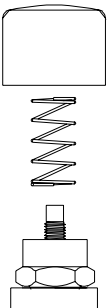
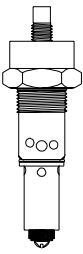
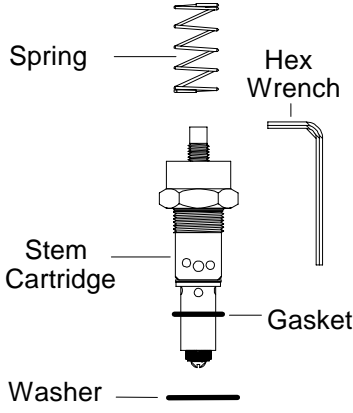
DISASSEMBLY	REPLACEMENT
<div style="border: 1px solid black; padding: 5px; margin-bottom: 10px;"> <div style="display: flex; justify-content: space-between;"> <div style="border: 1px solid black; padding: 2px; width: 30px; text-align: center; font-weight: bold;">1</div> <div> <p>1. Turn off water supplies. 2. Remove setscrew with 3/32 allen wrench.</p> </div> </div> <div style="text-align: center; margin-top: 10px;">  </div> </div> <div style="border: 1px solid black; padding: 5px; margin-bottom: 10px;"> <div style="display: flex; justify-content: space-between;"> <div style="border: 1px solid black; padding: 2px; width: 30px; text-align: center; font-weight: bold;">2</div> <div> <p>1. Unscrew push button handle and lift off spring.</p> </div> </div> <div style="text-align: center; margin-top: 10px;">  </div> </div> <div style="border: 1px solid black; padding: 5px;"> <div style="display: flex; justify-content: space-between;"> <div style="border: 1px solid black; padding: 2px; width: 30px; text-align: center; font-weight: bold;">3</div> <div> <p>1. Remove bonnet and stem cartridge by turning counterclockwise with adjustable wrench.</p> </div> </div> <div style="text-align: center; margin-top: 10px;">  </div> </div>	<div style="text-align: center; font-weight: bold; margin-bottom: 20px;"> <p>Use Only Genuine Central Replacement Parts</p> </div> <div style="margin-bottom: 10px;"> <p>K-170 Stem Cartridge Repair Kit</p> </div> <div style="text-align: center;">  </div>

Flow Time Adjustment

With locking set screw loose turn push button counterclockwise to lengthen flow time, clockwise to shorten flow length time. A five second cycle is recommended. Tighten the locking set screw with the hex wrench provided when desired time has been set.

CENTRAL BRASS MFG CO

2950 East 55th Street, Cleveland, Ohio 44127

Phone: 216-883-0220 Fax: 216-883-0875 Email: sales @CentralBrass.com